



REMØY SHIPPING

# HERMIT HORIZON



The vessel is designed as a platform supply vessel for worldwide operations with attention to seaworthiness, excellent station keeping performance and low fuel consumption and NOX-emission. The vessel is also suitable for Stand By and Oil Recovery operations. With its hull- and bow-design together with the specified propulsion configuration, the vessel is both environmentally friendly and optimized for any weather condition. The Vessel is manned for 24/7 continuous operation.

Vessel Name	HERMIT HORIZON
Vessel Call sign	LEFU
IMO No.	9747493
Owner	PEARL BIDCO
Port of registry	Aalesund, Norway
Delivery year	2016
Yard	VARD AUKRA, Norway
Design	VARD 1 08

# SPECIFICATIONS

## CLASS NOTATION:

DNV GL: 1A1 FIRE FIGHTER (1), Offshore Service Vessel, COMF (C-3, V-3), DK (+), DYNPOS (AUTR), E0, HL (2,8), ICE ©, LFL (\*), NAUT (OSV (A)), OILREC, SF, WINTERIZED (BASIC)

The vessel is fitted with:

- Good cargo capacities
- Modern, high standard accommodation
- Optimized cargo system
- Selective Catalytic Reduction (SCR) Advanced emissions control for diesel engines
- IEC 80005-3 Shore Connection: 2 x 300A/ 690V

## MAIN PARTICULARS:

Length overall	81.70 m
Length between p.p.	74.00 m
Breadth moulded	18.00 m
Depth main deck	7.80 m
Max t/m <sup>2</sup>	5 MT fwd of frame 35 10 MT aft of frame 35
Max. load line draft midship	6.50 m
Speed (at d=3.7 m, approx.)	14 knots
Consumption	6MT/d @ 10 kts 18MT/d @ 14 kts
ERN	99.99.99.99
Air draught	30,5 m

## POSITION REFERENCE SYSTEMS:

Laser  
DGPS  
RADius

## CAPACITIES:

ORO	1 223 m <sup>3</sup>
Cargo deck area (free area - 10T/5T/m <sup>2</sup> )	830 m <sup>2</sup>
Deck cargo (COG=1.0 above main deck)	2 200 t
Deadweight	4 100 t

## MAIN ENGINES GENERATOR SETS:

2 x main diesel engines, 2 250 ekW each, 690 V, 1 800 rpm  
2 x main diesel engines, 940 ekW each, 690 V, 1 800 rpm

## EMERGENCY GENERATOR SET:

1 x emergency generator set, 130 ekW, 690 V, 1 800 rpm

## THRUSTERS:

3 x electrical driven tunnel bow thrusters, approx. 930 kW each, frequency controlled

## MAIN PROPULSION:

2 x azimuth thrusters, electrical driven, frequency controlled propellers and water-cooled drives.  
Power: 1 600 ekW each







## DECK EQUIPMENT:

1 x Hydraulic deck / provision crane, 2T 17M

## ACCOMMODATION:

Accommodation and equipment for 28 persons

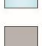
## TANK CAPACITIES:

Medium	Volume	No tanks	No pumps	m <sup>3</sup> /hour per pump
 Fuel oil	937 m <sup>3</sup>	16	2	200/100*
 Base oil	600 m <sup>3</sup>	8	1	100*
 Water Ballast / Drill Water	1 800 m <sup>3</sup>	24	2	150
 Fresh Water	573 m <sup>3</sup>	10	2	200
 Dry Bulk	300 m <sup>3</sup>	4		Compressed dried air
 Mud / Brine	1 223 m <sup>3</sup>	8	4	100*
 Methanol	222 m <sup>3</sup>	2	2	75 (100*)
ORO*	1 223 m <sup>3</sup>	10	8	100

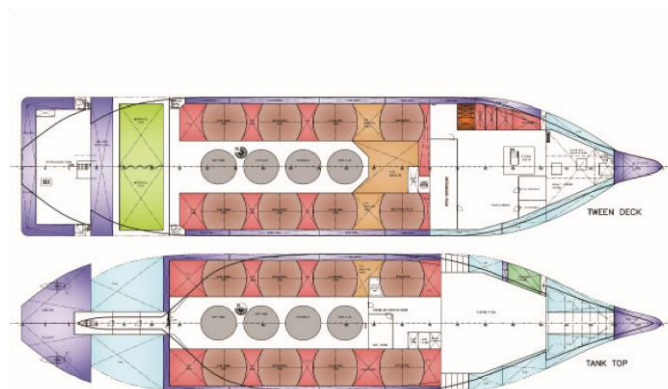

The 937m<sup>3</sup> of fuel oil is total for FO and Base oil tanks that could be configured for both mediums.  
The ORO capacity is partly made up by using mud/brine tanks and FO tanks.